

15

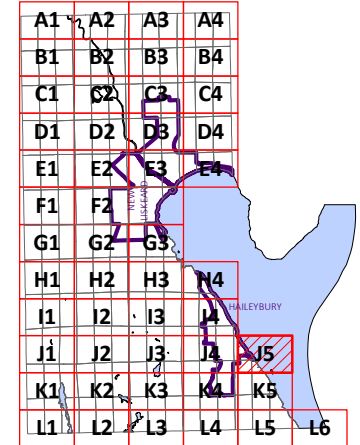
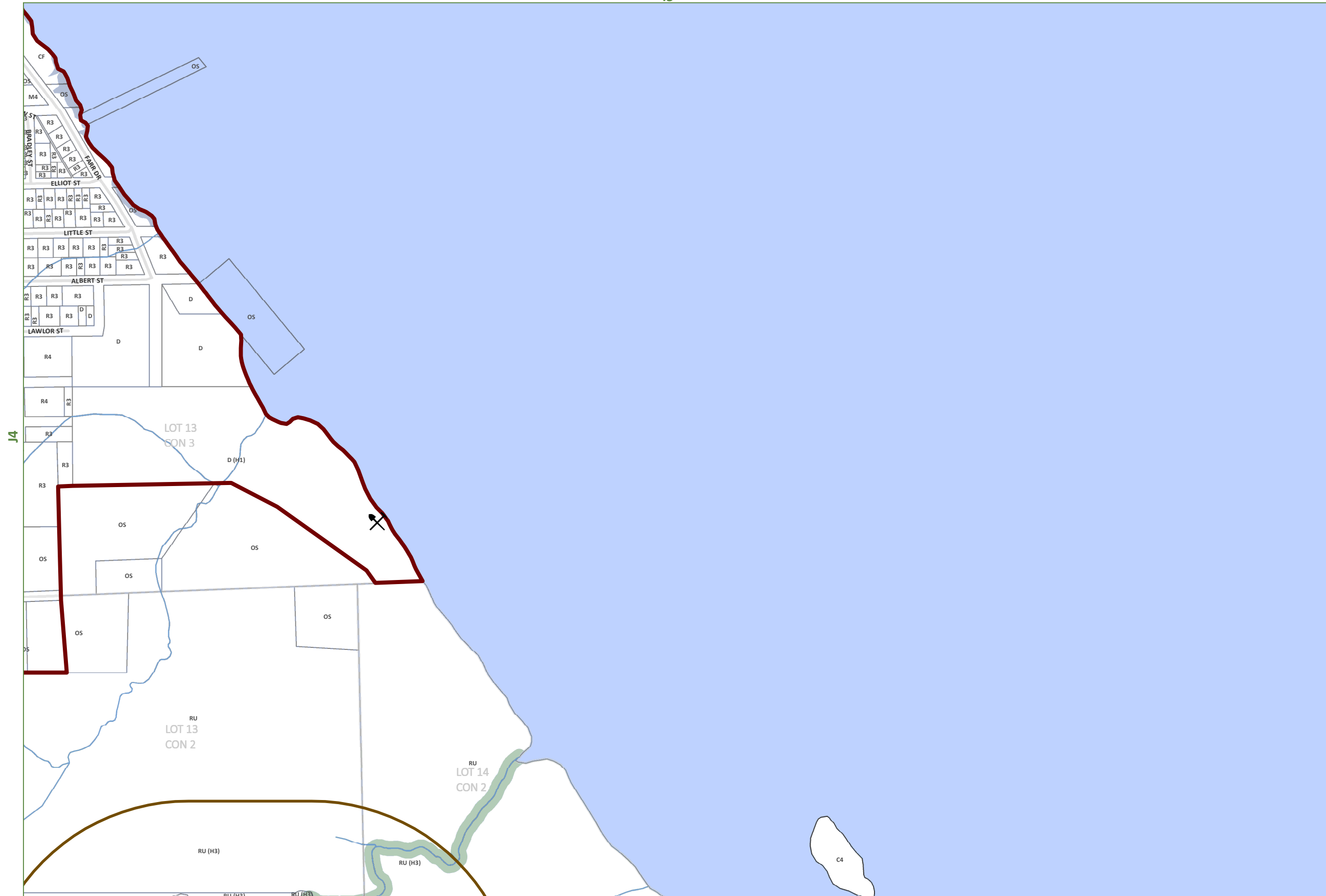

R1	Rural Residential	A1	Prime Agriculture
R2	Low Density Residential	RU	Rural
R3	Medium Density Residential	[Red Box]	Settlement Areas
R4	High Density Residential	[Purple Box]	Town Centre
MH	Mobile Home Residential	CF	Community Facility
D	Development	OS	Open Space Recreation
C1	General Commercial		
C2	Highway Commercial		
C3	Neighbourhood Commercial		
C4	Tourist Commercial		
MUA	Mixed Use-A		
M1	General Industrial		
M2	Manufacturing Industrial		
M3	Mineral Aggregate Resource	[Blue Line]	Watercourses
M4	Waste Management	[Black Line]	Railway
EP	Environmental Protection	[Green Box]	OVERLAY ZONES
[Pickaxe]	Mining Hazard Constraint	[Blue Area]	Floodplain
[Star]	Closed Land Fill	[Brown Area]	Influence Areas

"Where a zone symbol is followed by a dash (-) and a number (e.g. R1-17), the number refers to a site-specific exception that applies to that land"

"Where a zone symbol is followed by a Holding (H) and a number (e.g. H1), the lands are subject to the applicable holding provisions in Section 12 of the By-law"

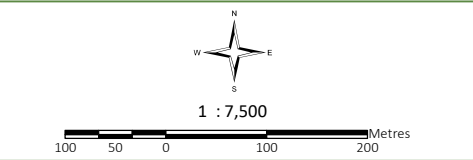

THIS MAP IS FOR ILLUSTRATION PURPOSES ONLY. THE INFORMATION DISPLAYED ON THESE MAPS HAS BEEN CREATED FROM MINISTRY OF NATURAL RESOURCES, ONTARIO BASE MAPPING & MPAC PROPERTY FABRICS. WHILE EVERY EFFORT HAS BEEN MADE TO ACCURATELY DEPICT THE INFORMATION, THIS MAP SHOULD NOT BE RELIED ON AS A PRECISED INDICATOR OF LOCATIONS OF FEATURES OR ROADS.

BASE MAPPING SOURCE:
MINISTRY OF NATURAL RESOURCES - ONTARIO BASE MAPPING
MPAC - MUNICIPAL PROPERTY ASSESSMENT CORPORATION

K5